

IAT-150REC Unit Outline

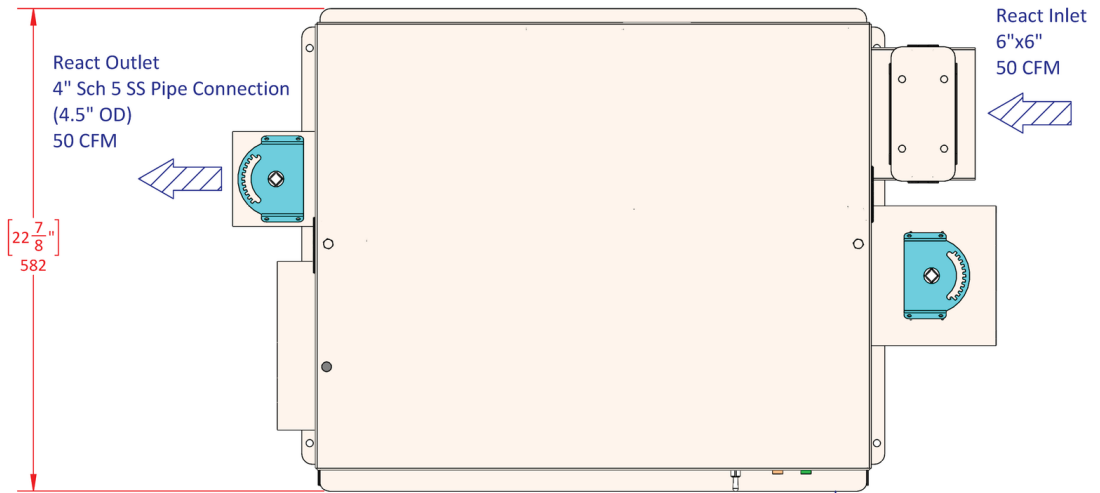

TOP VIEW

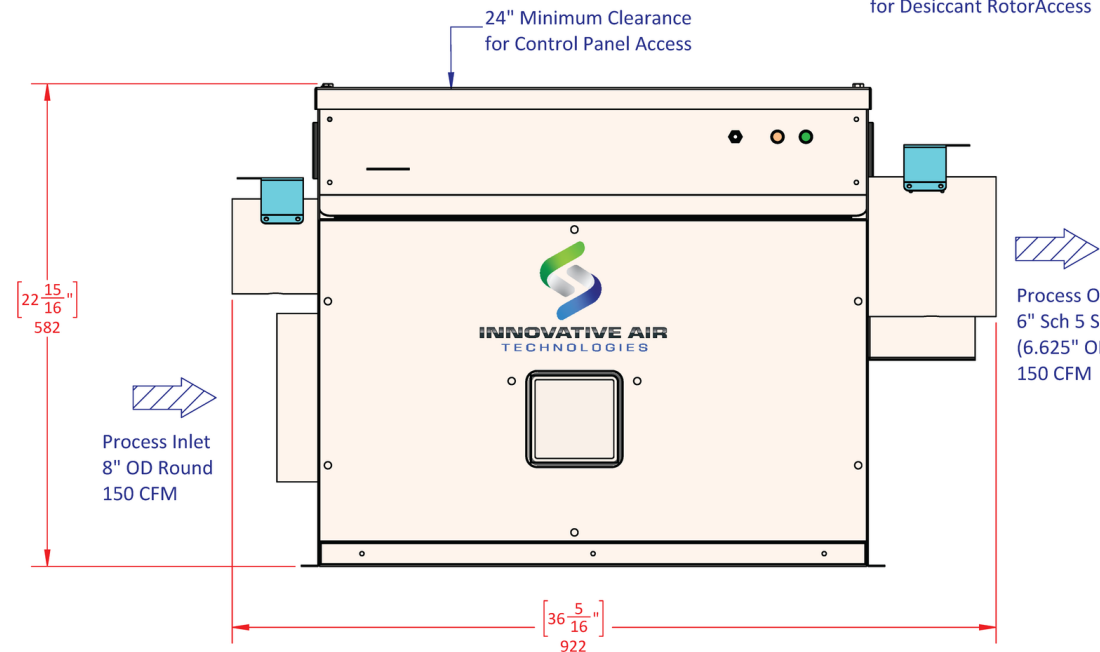

FRONT VIEW

SPECIFICATIONS:

- PROCESS AIR FLOW: 150 CFM
- REACTIVATION AIR FLOW: 50 CFM
- REACTIVATION HEAT: 9,725 BTUH
- TOTAL POWER CONSUMPTION: 3,850 WATTS
- DESICCANT ROTOR: SILICA GEL

TYPICAL PERFORMANCE:

- 75 DEG. F @ 50%RH - 5.0 LBS/HR.
- 75 DEG. F @ 30%RH - 3.2 LBS/HR.
- 75 DEG. F @ 10%RH - 1.0 LBS/HR.

GENERAL NOTES:

1. STAINLESS STEEL CONSTRUCTION.
2. REACT & PROCESS OUTLETS EQUIPPED WITH AIR VOLUME DAMPERS.
3. 30% REPLACEABLE FILTER.
4. ALLOW A MINIMUM OF 5% MAKE UP AIR ON PROCESS INLET.
5. SILICA GEL DESICCANT IS EMBEDDED IN ROTATING WHEEL.

AVAILABLE OPTIONS:

1. WEATHER PROOF CONSTRUCTION.
2. DUCT TRANSITIONS. SCH 5 PIPE TO STANDARD DUCT SIZES.
3. MIXED AIR BOXES.
4. SUBMIT CUSTOM REQUESTS TO INFO@DEHUMIDIFIERS.COM



INNOVATIVE AIR TECHNOLOGIES
 16200 GEORGIA PEACH AVE - COVINGTON, GA 30014
 PHONE: (770) 788-6744 | www.dehumidifiers.com

THE INFORMATION CONTAINED IN THIS DRAWING IS THE SOLE PROPERTY OF INNOVATIVE AIR TECHNOLOGIES, INC. ANY PARTIAL OR COMPLETE REPRODUCTION WITHOUT THE WRITTEN PERMISSION OF INNOVATIVE AIR TECHNOLOGIES, INC. IS PROHIBITED.

PROJECT: 150RE COMPACT - UNIT OUTLINE			
TITLE: IAT-150RE			
DWG NO: N/A	WEIGHT: 165 LBS		
DRAWN BY: JP	CHECK BY: KO	DATE: 10/11/2022	
SIZE: B	SCALE: -	SHEET: 1 OF 2	

IAT-150REC Unit Outline

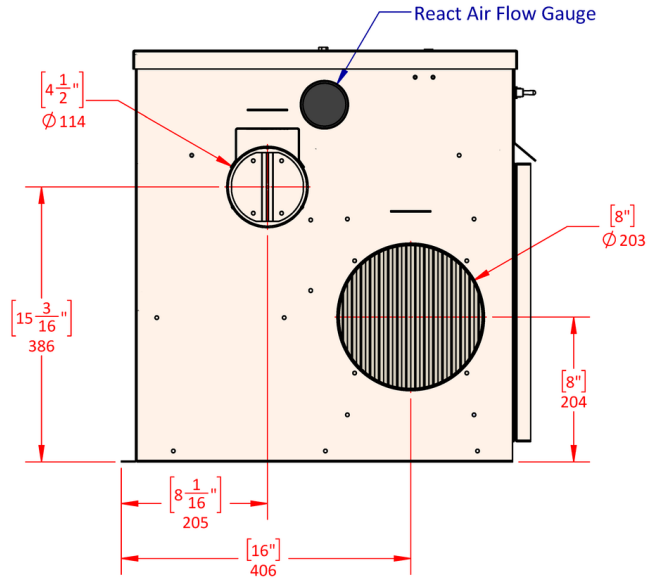

LH SIDE VIEW

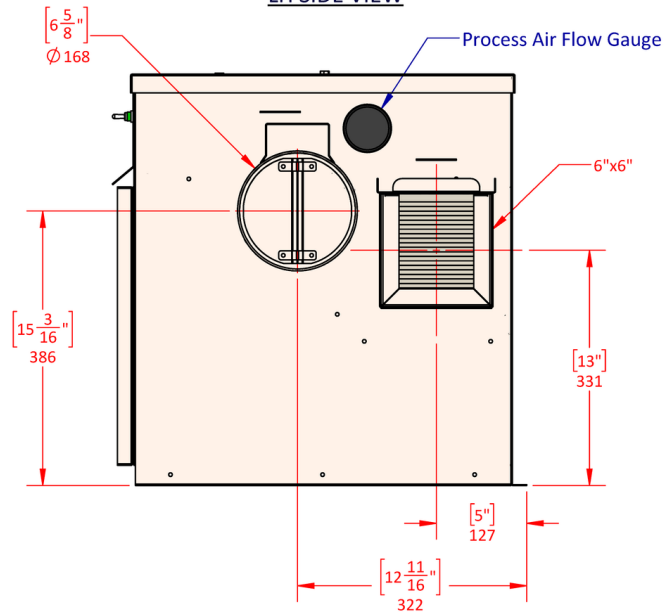

RH SIDE VIEW

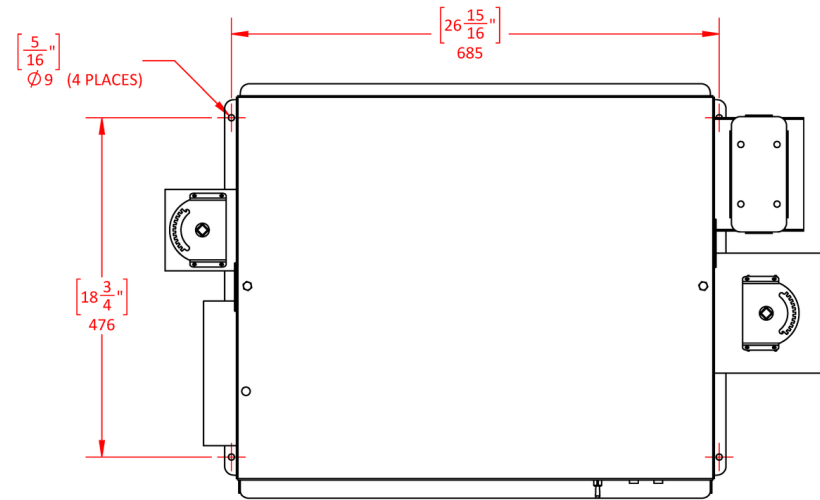

MOUNTING LOCATION DETAIL
(TOP VIEW)



**INNOVATIVE AIR
TECHNOLOGIES**

16200 GEORGIA PEACH AVE - COVINGTON, GA 30014
PHONE: (770) 788-6744 | www.dehumidifiers.com

THE INFORMATION CONTAINED IN THIS DRAWING IS THE SOLE PROPERTY OF INNOVATIVE AIR TECHNOLOGIES, INC. ANY PARTIAL OR COMPLETE REPRODUCTION WITHOUT THE WRITTEN PERMISSION OF INNOVATIVE AIR TECHNOLOGIES, INC. IS PROHIBITED.

PROJECT: 150RE COMPACT - UNIT OUTLINE		
TITLE: IAT-150RE		
DWG NO: N/A	WEIGHT: 165 LBS	
DRAWN BY: JP	CHECK BY: KO	DATE: 10/11/2022
SIZE: B	SCALE: -	SHEET: 2 OF 2

IAT-150REC General Specifications



Process Airflow	150 CFM		
Process Fan ESP	1.0" WC		
React airflow	50 CFM		
React Fan ESP	0.5" WC		
Weight	165 lbs.		
Height	23.0"		
Width	37"		
Depth	23"		
Process Inlet	8"		
Process Outlet	6.625" round		
React Inlet	6" x 6"		
React Outlet	4.5" round		
Filters	MERV 8		
Construction	18 Gauge Stainless		
Desiccant	Silica Gel		
Voltage options	Voltage	SCCR (KA)	FLA
	208/1/60	10	18.5 amps
	240/1/60	10	16.6 amps
	208/3/60	10	12.7 amps
	240/3/60	10	11.7 amps
	480/3/60	10	5.5 amps
	575/3/60	200	4.6 amps
Reactivation Heat	9,725 btuh		
Power Consumption	3,850 watts		
Performance Specs	75°F @ 50% RH - 5.0 lbs./hr. 75°F @ 30% RH - 3.2 lbs./hr. 75°F @ 10% RH - 1.0 lbs./hr.		
Decibel Level	78.6		

GENERAL NOTES:

- Stainless steel construction.
- React & process outlets equipped with air volume dampers.
- 30% replaceable filter.
- Allow a minimum of 5% make up air on process inlet.
- Silica gel desiccant is embedded in rotating wheel.

AVAILABLE OPTIONS:

- Weather-proof construction.
- Duct transitions: schedule 5 pipe to standard duct sizes.
- Mixed air boxes.